

THE FOREST ACT

The Forest (Oxford Forest Reserve) Order, 2016

In exercise of the powers conferred upon the Minister by section 5(a) of the Forest Act, and of every other power hereunto enabling, the following Order is hereby made:-

- Citation. 1. This Order may be cited as the Forest (Oxford Forest Reserve) Order, 2016.
- Schedule. 2. The areas specified in Part I of the Schedule which are delineated on the map set out in Part II thereof, is hereby declared to be a forest reserve and shall be known as the Oxford Forest Reserve.

SCHEDULE

(Paragraph (2))

Part I. Description of Area declared to be Oxford Forest Reserve

The forest reserve to be known as Oxford Forest Reserve is described as follows:

Block A

All that parcel of land situated in the parish of Manchester and containing by survey 272 acres 11.5 perches or 110.5 hectares; and butting and bounding as follows -

- | | |
|------------------|--|
| <i>Northerly</i> | on reserved road and lot 192 of said plan; |
| <i>Easterly</i> | on part of Arnos Vale registered at Volume 91 Folio 49 and in possession of J.A. Parnell and on lot 259 of Oxford Land Settlement; |
| <i>Southerly</i> | on Arnos Vale in the possession of Emma Green, Curtis Banton, Hubert Salkie and Ernest Cumming, lots 75, 74 and 69 to 61 of Oxford Land Settlement and on main road from Oxford to Mile Gully; |
| <i>Westerly</i> | on lots 248, 265 to 260, 250, 251 and 255 as shown on said plan or however otherwise the same land may be |

butted, bounded, known or otherwise described.

Block B

All that parcel of land part of Oxford Land Settlement and numbered as lot 254 on the Oxford Land Settlement Plan, deposited in the Registry of Titles at Volume 1350 Folio 960, situated in the parish of Manchester and containing by survey 27 acres 2 roods and 36.5 perches or 11.23 hectares; and butting and bounding as follows -

<i>Northerly</i>	on main road from Troy to Oxford and lot 254A of said plan;
<i>Easterly</i>	on lot 255 of said plan;
<i>Southerly</i>	on lots 251, 252 and 253 of said plan;
<i>Westerly</i>	on main road from Troy to Oxford as shown on said plan or however otherwise the same land may be butted, bounded, known or otherwise described.

Block C

All that parcel of land part of Oxford Land Settlement and numbered as lot 184 on the Oxford Land Settlement Plan, deposited in the Registry of Titles at Volume 1328 Folio 315, situated in the parish of Manchester and containing by survey 15 acres 4.4 perches or 6.08 hectares; and butting and bounding as follows -

<i>Northerly</i>	on Aughtenbeddie in the possession of Iron Jennings, Isaac Foster and Evans McFarlane;
<i>Easterly</i>	on road from Aughtenbeddie to Oxford and main road from Troy to Oxford;
<i>Southerly</i>	on lots 184A and 185 of said plan;
<i>Westerly</i>	on parochial road from Aughtenbeddie and lot 183 as shown on said plan or however otherwise the same land may be butted, bounded, known or otherwise described.

Block D

All that parcel of land part of Oxford Land Settlement and numbered as lot 258 on the Oxford Land Settlement Plan, deposited in the Registry of Titles at Volume 1350 Folio 961, situated in the parish of St. Elizabeth and containing by survey 17 acres 1 rood 17 perches or 7.03 hectares; and butting and bounding as follows -

<i>Northerly</i>	on Lookout in the possession of Arnold Mitchell;
<i>Easterly</i>	on lots 257, 163B, 164A and 165A of said plan;
<i>Southerly</i>	on reserved road;
<i>Westerly</i>	on lot 161 on said plan or however otherwise the same land may be butted, bounded, known or otherwise described.

Part II. Delineation of Oxford Forest Reserve (Block A, B, C and D)

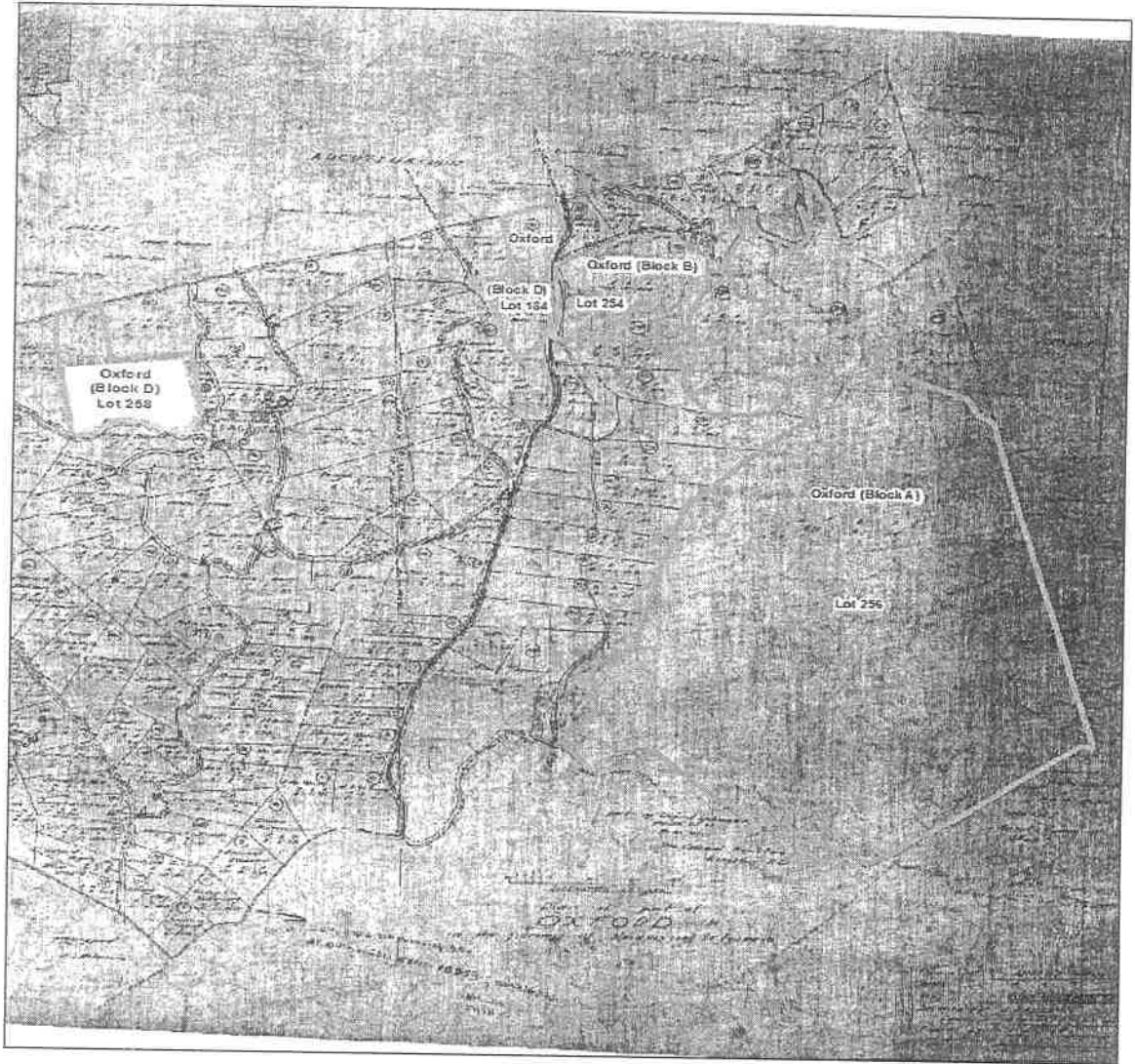

Oxford
Manchester and St. Elizabeth

N
Date: April 2013

Scale 1:12,500

Dated the *9th* day of *April*, 2016.

Minister of Economic Growth and Job Creation